

# RIKON

NEW &  
IMPROVED

## 10" Deluxe Bandsaw

Model 10-3061

### NEW Redesign Features

- ✓ Easy Fitting Dust Port
- ✓ Sturdy Door Hinges
- ✓ Adjustable Fence Carrier
- ✓ Easy Sliding Rip Fence System
- ✓ Easy cutting adjustments



### Standard Features

- ✓ Patented Spring Loaded Tool-less Guide System
- ✓ Quick-Release Blade Tension Lever
- ✓ 2 Blade Speeds 1,515 or 3,250 ft. / min
- ✓ Powerful 1/2 HP Motor
- ✓ Cutting Height of 5" with 9-5/8" Width

### Specifications

MOTOR		CUTTING CAPACITY		OVERALL DIMENSIONS	
Horsepower	1/2 HP	Height	5"	Height	34-1/4"
Amps	5.5	Width	9-5/8"	Width	21"
Volts	110V, 60Hz			Depth	16-1/4"
Speed	1,720 RPM			Base Size (WxD)	15-7/8" x 9-3/8"
BLADE		TABLE		Dust Port	2-1/2" O.D. 2-1/4" I.D.
Width	1/8" - 1/2"	Size	13-3/4" x 12-1/2"	Net Weight	77.5 lbs.
Length	70-1/2"	Left Tilt	5°	Gross Weight	86 lbs.
2 Blade Speeds	1,515/ 3,280 ft/min	Right Tilt	45°	Shipping Width	35-1/2"
Includes	5/16" x 6TPI	Miter Guage Slot	5/8" x 1/4"	Shipping Depth	12-3/4"
		Height to Base	14-1/2"	Shipping Height	18-1/4"
		Height to Floor (with 13-913 stand)	39-7/8"		
		Fence Size (L x H)	12-1/4" x 2-3/8"		

Call today for more information **877-884-5167**  
or visit **www.rikontools.com** for a dealer near you!



# RIKON

**NEW & IMPROVED**

## 10" Deluxe Bandsaw

Model 10-3061

**NEW & IMPROVED**



**Adjustable Fence Carrier**

**Dust Port Design**



## Accessories



**12-201**

LED Gooseneck Worklight with Magnetic Base and Magnetic Clip



**13-913**

Optional 10" Bandsaw Stand  
Top: 14-1/2" x 9-3/4"  
Base: 25" x 18-3/4"  
Height: 25"



**13-920**

Miter Gauge Aluminum body with 60° scale for left and right settings

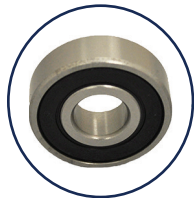

**C10-109**

Replacement Guide Bearings Pack of 6



**C10-393**

Replacement Table Inserts Pack of 4

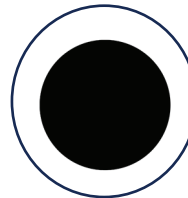

**C10-394**

Zero Clearance Inserts Pack of 4

### BANDSAW BLADES

Length	Width	Gauge	TPI	Style	Item No.
* 70-1/2"	1/8"	.018"	8	Hook Tooth	19-7006 *
* 70-1/2"	1/8"	.018"	14	Hook Tooth	19-7007 *
70-1/2"	3/16"	.025"	10	Reg. Tooth	19-7002
70-1/2"	1/4"	.025"	6	Hook Tooth	19-7003
70-1/2"	3/8"	.025"	4	Hook Tooth	19-7004
70-1/2"	1/2"	.025"	3	Hook Tooth	19-7005

\* Using a 1/8" blade requires an aftermarket blade stabilizer

Call today for more information **877-884-5167**  
or visit **www.rikontools.com** for a dealer near you!

