

# RIKON

## 10" Deluxe Bandsaw

Model #10-306



- ✓ Spring Loaded Tool-less Blade Guides
- ✓ Quick-Release Blade Tension Lever
- ✓ 2 Blade Speeds 1,515 or 3,250 ft. / min
- ✓ Improved Rip Fence System
- ✓ More Powerful 1/2 HP Motor
- ✓ Convenient 45° Table Tilting Stop

- ✓ Increased Cutting Height of 5" with 9-5/8" Width
- ✓ Improved Dust Collection System
- ✓ Larger Blade Tracking Knob
- ✓ Windows Added for Viewing Blade Tracking
- ✓ Convenient Holders for Fence & Tools
- ✓ Strengthened Frame & Base Construction

### Specifications:

MOTOR		CUTTING CAPACITY		OVERALL DIMENSIONS	
Horsepower	1/2 HP	Height	5"	Height	34-1/4"
Amps	5.5	Width	9-5/8"	Width	21"
Volts	110V, 60Hz			Depth	16-1/4"
Speed	1,720 RPM	TABLE		Base Size (WxD)	15-7/8" x 9-3/8"
		Size	13-3/4" x 12-1/2"	Dust Port	2-1/2" O.D. 2-1/4" I.D.
		Left Tilt	5°	Net Weight	77.5 lbs.
		Right Tilt	45°	Gross Weight	86 lbs.
		Miter Gauge Slot	5/8" x 1/4"	Shipping Width	35-1/2"
		Height to Base	14-1/2"	Shipping Depth	12-3/4"
		Height to Floor (with 13-913 stand)	39-7/8"	Shipping Height	18-1/4"
		Fence Size	12-1/4" x 2-3/8"		
BLADE					
Width	1/8" - 1/2"				
Length	70-1/2"				
2 Blade Speeds	1,515/ 3,280 ft/min				
Includes	5/16" x 6TPI				

Call today for more information **877-884-5167**  
or visit **www.rikontools.com** for a dealer near you!



# RIKON

## 10" Deluxe Bandsaw Model #10-306



## Accessories



**12-201**

LED Gooseneck Worklight  
with Magnetic Base and  
Magnetic Clip



**13-913**

Optional 10" Bandsaw Stand  
Top: 14-1/2" x 9-3/4"  
Base: 25" x 18-3/4"  
Height: 25"



**13-920**

Miter Gauge  
Aluminum body with 60°  
scale for left and  
right settings

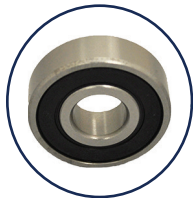

**C10-109**

Replacement Guide Bearings  
Pack of 6



**C10-393**

Replacement Table Inserts  
Pack of 4

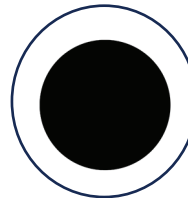

**C10-394**

Zero Clearance Inserts  
Pack of 4

### BANDSAW BLADES

Length	Width	Gauge	TPI	Style	Item No.
70-1/2"	1/8"	.018"	8	Hook Tooth	19-7006
70-1/2"	1/8"	.018"	14	Hook Tooth	19-7007
70-1/2"	3/16"	.025"	10	Reg. Tooth	19-7002
70-1/2"	1/4"	.025"	6	Hook Tooth	19-7003
70-1/2"	3/8"	.025"	4	Hook Tooth	19-7004
70-1/2"	1/2"	.025"	3	Hook Tooth	19-7005

Call today for more information **877-884-5167**  
or visit **www.rikontools.com** for a dealer near you!

